

Front view

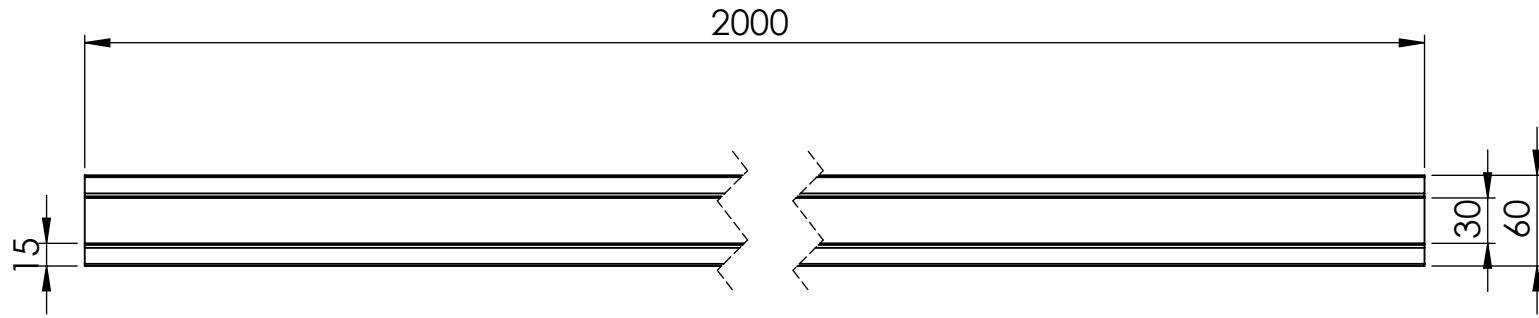

Side view

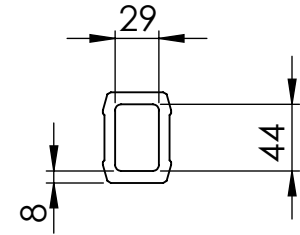

Top view

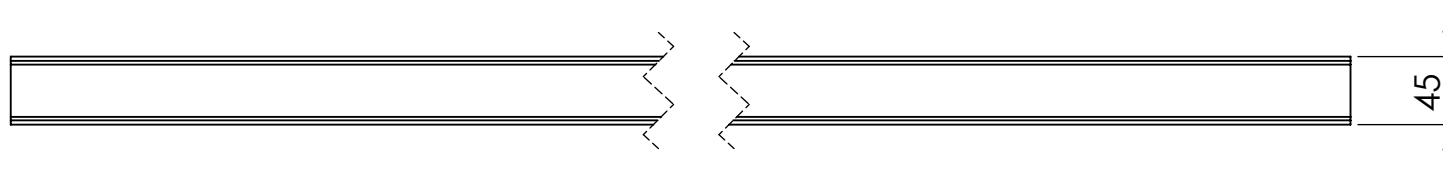

Drawn by : bvgрма	Date: 01-02-2013	Finish : Anodised aluminium and plastic cover in the open profile	SCALE:1:5	General tolerances according to Norm ISO 2768-1		
Checked by : mderpu	Date : 01-02-2013					
Revision : 01				Fine	Medium	Coarse
		Swing arms accessories, Operator arm section profile		Reference number :		
		60 mm x 45 mm x 2000 mm		SAS200CSL		
				A4		
				Page 1/1		