

Shield (Screen) Connecting System Description and Handling



Carrier with grounding foot
45 mm/1.772 in long, busbar 90° to the rail
Item No. 790-113



Carrier with grounding foot
45 mm/1.772 in long, busbar parallel to the rail
Item No. 790-114



Carrier with 2 grounding feet
125 mm/4.921 in long, busbar parallel to the rail
Item No. 790-115

for all sizes of shield (screen) clamping saddles

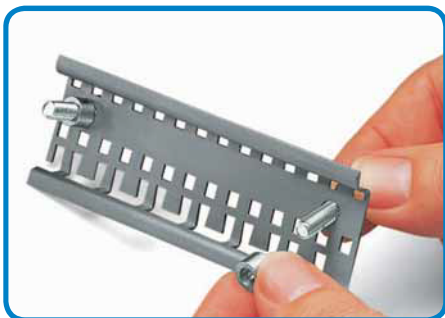

Using a stand off
with a special slotted carrier rail

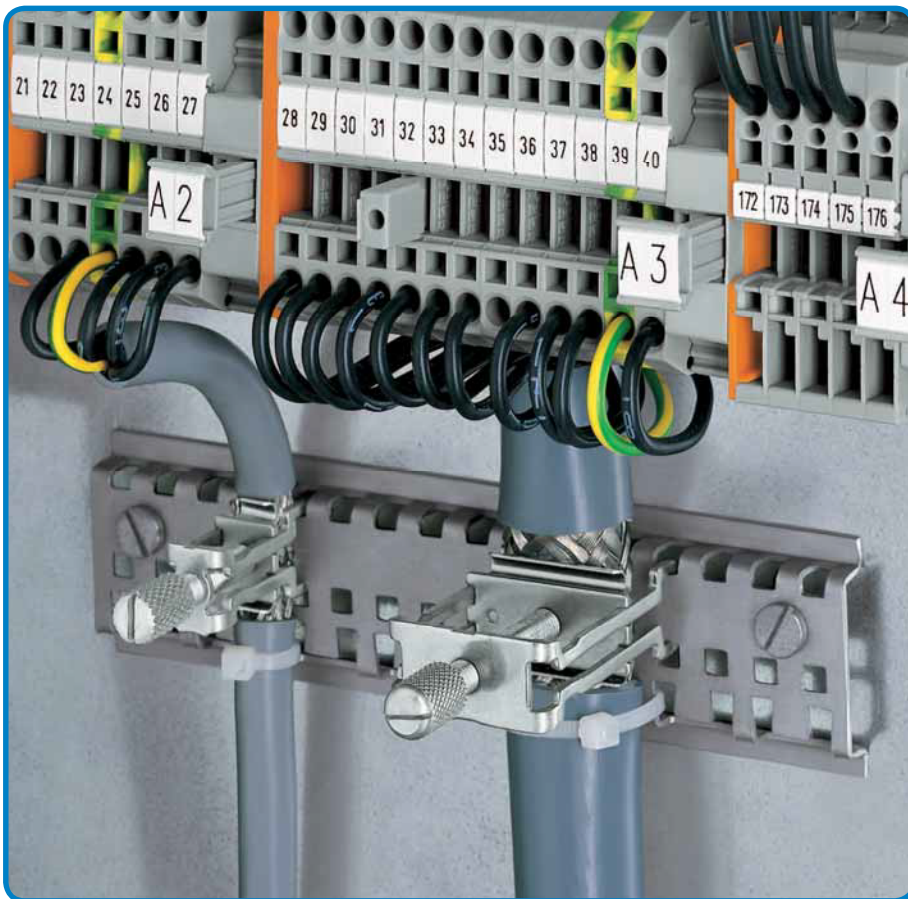

Addition of a shield (screen) clamping saddle.

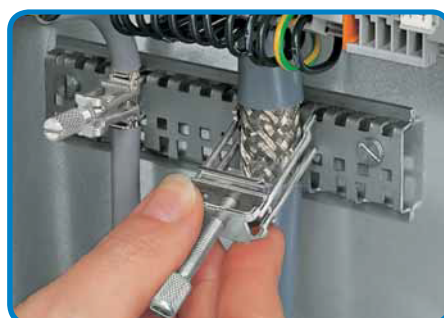

Tightening/releasing a shield (screen) clamping saddle. To attach the clamping saddle, tighten the knurled screw. To remove, unscrew until ratcheted mechanism is released, then slightly tip saddle and remove the clamping saddle.

Mounting Options Based on Application

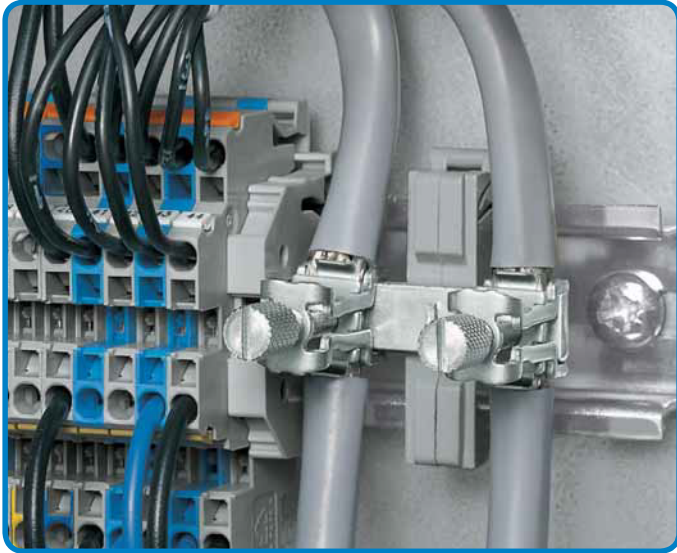

- carrier with grounding foot, busbar parallel to the rail



- isolated mounting carriers for a common shield (screen) reference potential, independent of the housing potential



- U-shaped copper busbar 10 mm (0.394 in) x 3 mm (0.118 in)

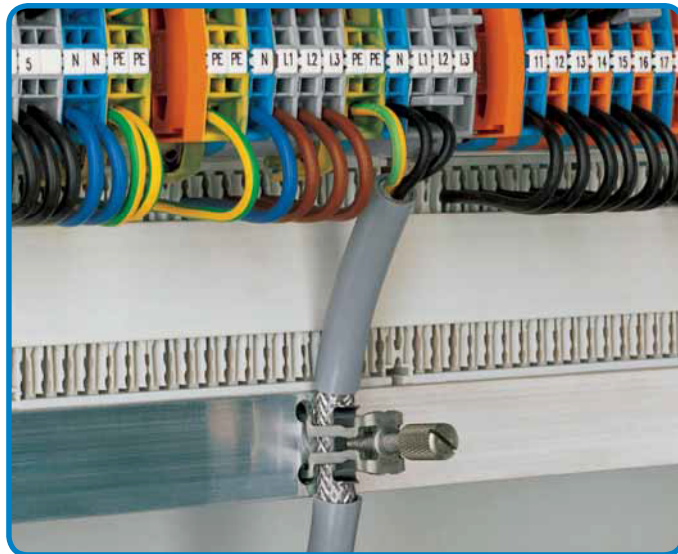

- snap into any metal plate up to max. thickness 3 mm/0.118 in

Negative shield (screen) attenuation

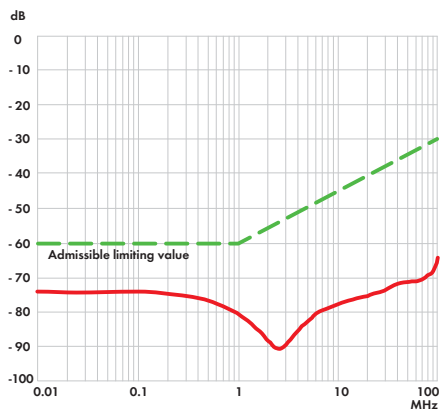

Shield (screen) clamping saddle size

Distance X
11 mm 9.5 mm

Distance Y
19 mm 17.5 mm
27 mm 25.5 mm
43 mm 41.5 mm

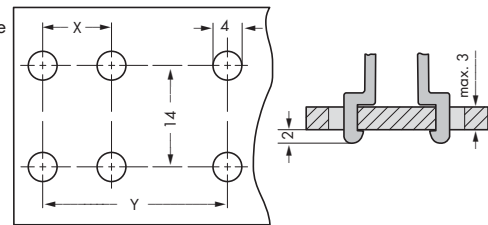

Hole dimensions for panel mounting

The WAGO shield (screen) connecting system is highly effective because the clamping unit can be brought very close to the unshielded part of the cable. Additionally, the spring material is part of the clamping saddle, giving good electrical connection and compensating for any deformation in the braiding. The system also acts as a partial strain relief.

Accessories for Shield (Screen) Clamping Saddles and Shield (Screen) Clamps

Carrier with grounding foot



Description		Item No.	Pack. Unit
Carrier with grounding foot	bar 90° to the rail, 10 mm (0.394 in) x 3 mm (0.118 in), bar a. foot - Cu with tin plating, 45 mm/1.774 in long	790-113	25
Carrier with grounding foot	bar parallel to the rail, 10 mm (0.394 in) x 3 mm (0.118 in), bar a. foot - Cu with tin plating, 15 mm/0.591 in long	790-110	25
Carrier with grounding foot	bar parallel to the rail, 10 mm (0.394 in) x 3 mm (0.118 in), bar a. foot - Cu with tin plating, 25 mm/0.986 in long	790-112	25
Carrier with grounding foot	bar parallel to the rail, 10 mm (0.394 in) x 3 mm (0.118 in), bar a. foot - Cu with tin plating, 45 mm/1.774 in long	790-114	25
Carrier with 2 grounding feet	bar parallel to the rail, 10 mm (0.394 in) x 3 mm (0.118 in), bar a. foot - Cu with tin plating, 125 mm/4.929 in long	790-115	25

Suitable shield (screen) clamping saddle or shield (screen)

clamps for carrier with grounding foot 790-110 = 790-108;

Carrier with grounding foot 790-112 = 790-108, 790-116, 791-111, 791-117;

Carrier with grounding foot 790-114 = 790-108, 790-116, 790-124, 790-140, 791-107, 791-111, 791-117, 791-124

Carrier rail

Stand off

Shield termination

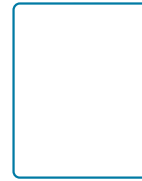

Description		Item No.	Pack. Unit
Carrier rail	special slotted, 1000 mm/3'3" long, Cu with tin plating, special lengths on request	790-145	1
Stand off	for special slotted carrier rail, use M 5 size screw	790-144	200 (2x100)
Shield termination including cable tie for shield			
diameter 5 mm /0.197 in to 10 mm /0.394 in	55 mm/2.169 in long	709-350	100 (4x25)
	150 mm/ 5.914 in long	709-352	100 (4x25)

Straight busbar

Isolated mounting foot

Isolated mounting foot

U-shaped busbar

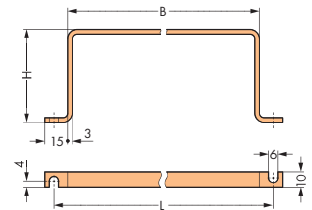

Description		Item No.	Pack. Unit
Straight busbar, 10 mm (0.394 in) x 3 mm (0.118 in), bar - Cu with tin plating	1000 mm/3'3" long	210-133	20 (20x1)
	30 mm/1.181 in long	790-133	20 (20x1)
	50 mm/1.969 in long	790-134	20 (20x1)
Isolated mounting foot	for busbar, with standard screw M 4 x 8 mm	790-100	50 (2x25)
Isolated mounting foot	for busbar, with sheet metal screw (3.5 x 9) mm	790-101	50 (2x25)
U-shaped busbar, 10 mm (0.394 in) x 3 mm (0.118 in), Cu with tin plating	Dimensions (W x H x L) mm; 63 x 60 x 83	790-190	25 (5x5)
	Dimensions (W x H x L) mm; 100 x 60 x 118	790-191	25 (25x1)
	Dimensions (W x H x L) mm; 63 x 35 x 83	790-192	25 (5x5)
	Dimensions (W x H x L) mm; 100 x 35 x 118	790-193	25 (25x1)

Busbar carrier

Busbar carrier, angulate

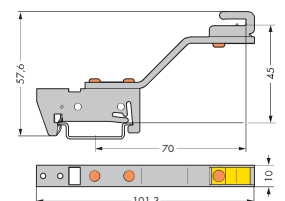
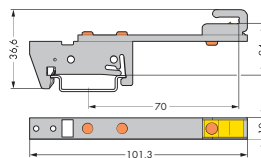

Description		Item No.	Pack. Unit
Busbar carrier	for busbars, 10 mm (0.394 in) x 3 mm (0.118 in) - Cu with tin plating	790-300	10
Busbar carrier, angulate	for busbars, 10 mm (0.394 in) x 3 mm (0.118 in) - Cu with tin plating	790-301	10