

Shield (Screen) Connecting System Description and Handling



Carrier with grounding foot
45 mm/1.772 in long, busbar 90° to the rail
Item No. 790-113



Carrier with grounding foot
45 mm/1.772 in long, busbar parallel to the rail
Item No. 790-114



Carrier with 2 grounding feet
125 mm/4.921 in long, busbar parallel to the rail
Item No. 790-115

for all sizes of shield (screen) clamping saddles



Using a stand off
with a special slotted carrier rail

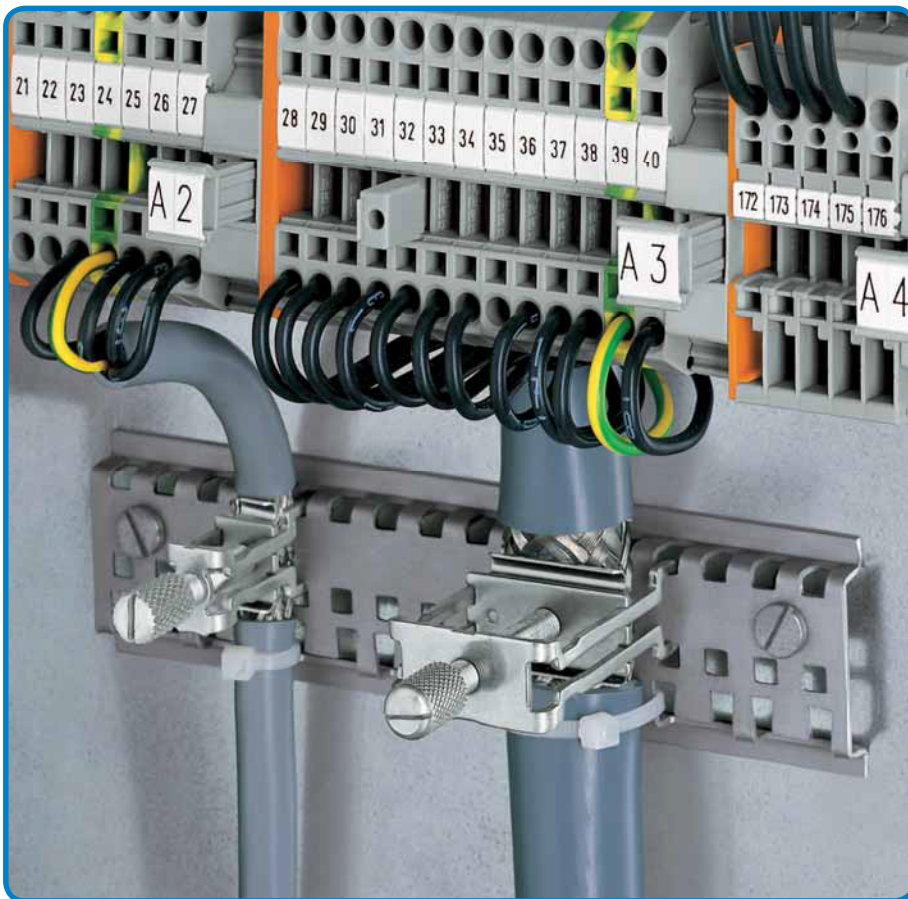

Addition of a shield (screen) clamping saddle.



Tightening/releasing a shield (screen) clamping saddle. To attach the clamping saddle, tighten the knurled screw. To remove, unscrew until ratcheted mechanism is released, then slightly tip saddle and remove the clamping saddle.

Mounting Options Based on Application

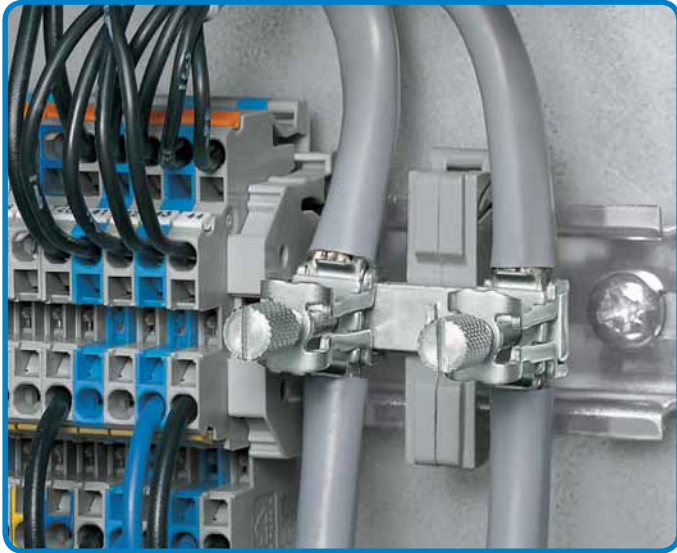

- carrier with grounding foot, busbar parallel to the rail



- isolated mounting carriers for a common shield (screen) reference potential, independent of the housing potential



- U-shaped copper busbar 10 mm (0.394 in) x 3 mm (0.118 in)

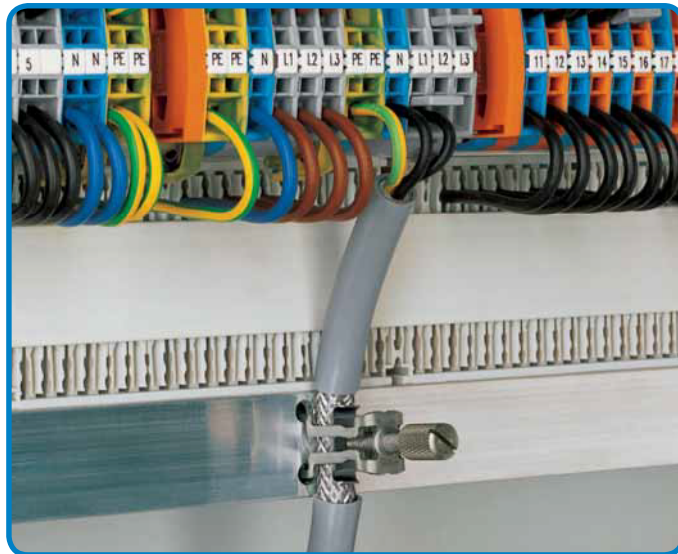

- snap into any metal plate up to max. thickness 3 mm/0.118 in

Negative shield (screen) attenuation

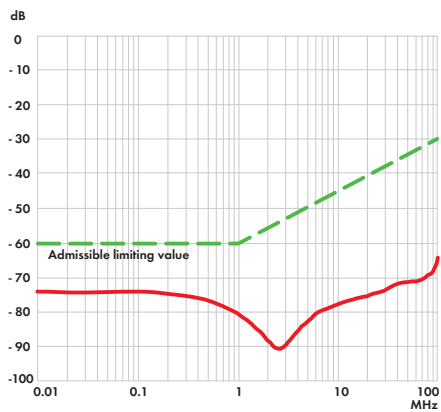

Shield (screen) clamping saddle size

| | | |
|------------|-------|---------|
| Distance X | 11 mm | 9.5 mm |
| Distance Y | 19 mm | 17.5 mm |
| | 27 mm | 25.5 mm |
| | 43 mm | 41.5 mm |

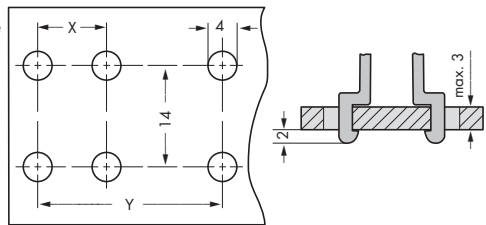

Hole dimensions for panel mounting

The WAGO shield (screen) connecting system is highly effective because the clamping unit can be brought very close to the unshielded part of the cable. Additionally, the spring material is part of the clamping saddle, giving good electrical connection and compensating for any deformation in the braiding. The system also acts as a partial strain relief.

Shield (screen) clamping saddles

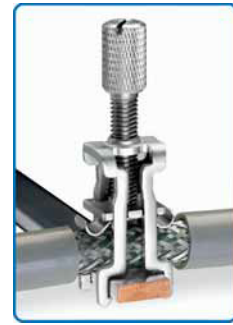

| Description | Diameter of Connectable Conductor | | Item No. | Pack. Unit |
|--|-----------------------------------|----------------------------------|----------|------------|
| Shield (screen) clamping saddle, incl. knurled screw | 11 mm/0.433 in wide | up to 8 mm/0.315 in | 790-108 | 50 (5x10) |
| | 19 mm/0.748 in wide | 7 mm/0.276 in to 16 mm/0.63 in | 790-116 | 50 (5x10) |
| | 27 mm/1.063 in wide | 6 mm/0.236 in to 24 mm/0.944 in | 790-124 | 50 (5x10) |
| | 43 mm/1.693 in wide | 22 mm/0.866 in to 40 mm/1.575 in | 790-140 | 50 (5x10) |

Note: Not for ground connections!

Recommended tightening torque: 0.5 Nm

Assembly: The shield (screen) clamping saddle is shipped ready for direct connection to the busbar 10 mm (0.394 in) x 3 mm (0.118 in) or to a drilled mounting plate. After connection, tighten the knurled screw to complete the installation.

Removal: To remove a shield (screen) clamping saddle, unscrew until ratcheted mechanism is released, then slightly tip saddle and remove the clamping saddle.

Assembly



Removal



Installation position delivery

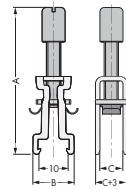

Closed position

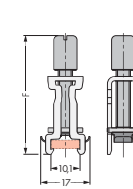

Removal position

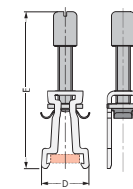

| Item No. | Dimensions in mm | | | | | |
|----------|------------------|----|----|----|-----|----|
| | A | B | C | D | E | F |
| 790-108 | 51 | 15 | 8 | 16 | 55 | 42 |
| 790-116 | 53 | 15 | 16 | 16 | 57 | 45 |
| 790-124 | 78 | 15 | 24 | 16 | 83 | 58 |
| 790-140 | 97 | 15 | 40 | 16 | 100 | 73 |

Shield (screen) clamps

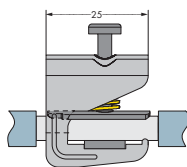
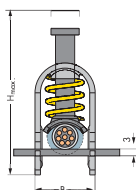

| Description | Diameter of Connectable Conductor | | Item No. | Pack. Unit |
|------------------------|-----------------------------------|------------------------------------|----------|------------|
| Shield (screen) clamps | H _{max} 40 mm, B 10 mm | 1.5 mm/0.059 in to 6.5 mm/0.256 in | 791-107 | 50 |
| | H _{max} 47 mm, B 17 mm | 5 mm/0.197 in to 11 mm/0.434 in | 791-111 | 50 |
| | H _{max} 63 mm, B 23 mm | 10 mm/0.394 in to 17 mm/0.670 in | 791-117 | 50 |
| | H _{max} 78 mm, B 30 mm | 16 mm/0.631 in to 24 mm/0.946 in | 791-124 | 50 |

Note: Not for ground connections!