

**Crimping contact  
HDC-C-HD-BM0.75-1.00AG**

**Weidmüller Interface GmbH & Co. KG**  
Klingenbergstraße 16  
D-32758 Detmold  
Germany  
Fon: +49 5231 14-0  
Fax: +49 5231 14-292083  
www.weidmueller.com

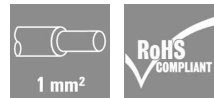

Crimps provide a electrical and mechanical connection between wire and contact that is both secure and reliable. The optimal crimp connection is gas-tight and corrosion-resistant.

**General ordering data**

Type	HDC-C-HD-BM0.75-1.00AG
Order No.	<a href="#">1601760000</a>
Version	Heavy Duty Connectors, Contact, HD, HDD, HQ, MixMate, CM 10, CM BUS (CSB), Female, Conductor cross-section, max.: 1, turned, Copper alloy
GTIN (EAN)	4008190158354
Qty.	100 pc(s).

**Datenblatt**

**Crimping contact  
HDC-C-HD-BM0.75-1.00AG**

**Weidmüller Interface GmbH & Co. KG**  
 Klingenbergstraße 16  
 D-32758 Detmold  
 Germany  
 Fon: +49 5231 14-0  
 Fax: +49 5231 14-292083  
 www.weidmueller.com

**Technische Daten**

**Dimensions and weights**

Net weight	0.6 g	Diameter	3.5 mm
------------	-------	----------	--------

**General data**

Contact diameter, male Ø	1.6 mm	Production methods	turned
Stripping length, rated connection	8 mm	Type	Female
Type of connection	Crimp connection	Material	Copper alloy
Series	HD	Surface finish	silver
Volume resistance	≤ 4mΩ		

**Classifications**

ETIM 3.0	EC000796	UNSPSC	30-21-18-01
eClass 5.1	27-14-34-19	eClass 6.2	27-26-12-02
eClass 7.1	27-44-02-04		

**Product information**

Descriptive text accessories	For further accessories, see chapter J - tools, see chapter K
------------------------------	---

**Approvals**

Approvals



ROHS	Conform
------	---------

**Datenblatt**

**Crimping contact  
HDC-C-HD-BM0.75-1.00AG**

**Weidmüller Interface GmbH & Co. KG**  
 Klingenbergstraße 16  
 D-32758 Detmold  
 Germany  
 Fon: +49 5231 14-0  
 Fax: +49 5231 14-292083  
 www.weidmueller.com

**Zeichnungen**

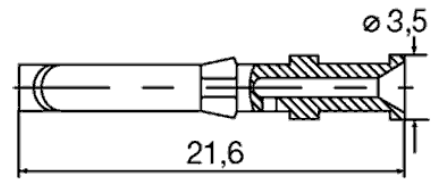
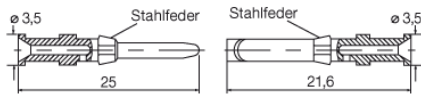

Leiterquerschnitt	Abisolierlänge
0,14 - 0,37 mm <sup>2</sup>	AWG 26-22 8 mm
0,50 mm <sup>2</sup>	AWG 20 8 mm
0,75 - 1,00 mm <sup>2</sup>	AWG 18 8 mm
1,50 mm <sup>2</sup>	AWG 16 8 mm
2,50 mm <sup>2</sup>	AWG 14 8 mm