



## Single-beam photoelectric safety switch L28

L28E-3P2431, L28S-3D2431



**Receiver**

Model Name > L28E-3P2431  
Part No. > 2044516



**Sender**

Model Name > L28S-3D2431  
Part No. > 2044515



**At a glance**

- Universal use up to Type 2, with safety controller solutions from SICK
- Compact size with ranges up to 18 m
- Plastic housing, ABS
- Temperature range from -40 °C ... + 55 °C
- Enclosure rating IP 67

**Your benefits**

- Easy integration due to small, compact versions with maximum range
- Directly connect to a safety controller - without a separate evaluation unit, reducing costs
- Flexible device integration makes it possible to set up individual protective fields
- Well suited to withstand extreme ambient conditions such as heat, cold or moisture



**Applications**

Access protection (vertical): 1

**Technical Data-Sender**

Typical range: 0 m ... 12 m  
 Maximum scanning range: 0 m ... 18 m  
 Number of beams: 1  
 Light spot diameter (distance): 300 mm (10 m)  
 Aperture angle/receiving angle: according to type 2 (IEC 61496-2)  
 Light sender/type of light: LED/visible red light  
 Wave length: 660 nm  
 Average service life (TA): 100,000 h (25 °C)  
 Protection class: II  
 Enclosure rating: IP 67

Type:	Type 2 (EN 61496) <sup>1)</sup>
Safety integrity level:	SIL1 (IEC 61508) SILCL1 (IEC 62061) <sup>2)</sup>
Category:	category 2 (EN ISO 13849) <sup>3)</sup>
Test rate (external test):	100 /s (EN ISO 13849) <sup>4)</sup>
Maximum demand rate:	60 /min (EN ISO 13849) <sup>5)</sup>
Performance level:	PL c (EN ISO 13849) <sup>6)</sup>
PFHd:	1.0 * 1E-06 <sup>7)</sup>
TM (mission time):	20 a
Supply voltage typical, from, to:	24 V DC, 16.8 V DC, 28.8 V DC <sup>8)</sup>
Maximum power consumption:	≤ 35 mA
Diagnostic display:	LED
Design:	Rectangular
Dimensions (W x H x D):	75.5 mm x 17.6 mm x 33.5 mm
Connection type:	plug M12 x 4
Housing material:	ABS
Ambient operating temperature from ... to:	-40 °C ... 60 °C
Storage temperature from ... to:	-40 °C ... 75 °C
Weight:	40 g

1) 2) 3) 6) 7) Only in conjunction with suitable testing device, e.g., Flexi Classic, DeviceNet Safety <sup>4)</sup> The test rate shall not be exceeded <sup>5)</sup> Between two demands on a safety-related response of the device, at least 100 internal or external tests must be carried out. <sup>8)</sup> Reverse polarity protected

## Technical Data-Receiver

Typical range:	0 m ... 12 m
Maximum scanning range:	0 m ... 18 m
Number of beams:	1
Light spot diameter (distance):	300 mm (10 m)
Aperture angle/receiving angle:	according to type 2 (IEC 61496-2)
Protection class:	II
Enclosure rating:	IP 67
Type:	Type 2 (EN 61496) <sup>1)</sup>
Safety integrity level:	SIL1 (IEC 61508) SILCL1 (IEC 62061) <sup>2)</sup>
Category:	category 2 (EN ISO 13849) <sup>3)</sup>
Test rate (external test):	100 /s (EN ISO 13849) <sup>4)</sup>
Maximum demand rate:	60 /min (EN ISO 13849) <sup>5)</sup>
Performance level:	PL c (EN ISO 13849) <sup>6)</sup>
PFHd:	1.0 * 1E-06 <sup>7)</sup>
TM (mission time):	20 a
Supply voltage typical, from, to:	24 V DC, 16.8 V DC, 28.8 V DC <sup>8)</sup>
Switching outputs:	PNP, Q and Q not <sup>9)</sup>
Maximum switching sequence:	1,000 Hz
Maximum switching current:	100 mA
Maximum power consumption:	≤ 25 mA
Diagnostic display:	LED
Design:	Rectangular
Dimensions (W x H x D):	75.5 mm x 17.6 mm x 33.5 mm
Connection type:	plug M12 x 4
Housing material:	ABS
Ambient operating temperature from ... to:	-40 °C ... 60 °C
Storage temperature from ... to:	-40 °C ... 75 °C

Weight:

40 g

1) 2) 3) 6) 7) Only in conjunction with suitable testing device, e.g., Flexi Classic, DeviceNet Safety 4) The test rate shall not be exceeded 5) Between two demands on a safety-related response of the device, at least 100 internal or external tests must be carried out. 8) Reverse polarity protected 9) Short-circuit protected, interference suppression

**Dimensional drawing**

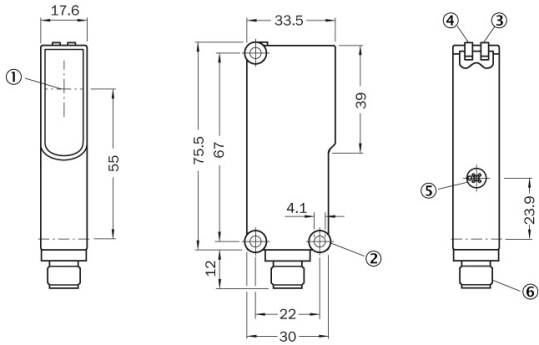

**Australia**

Phone +61 3 9457 0600  
1800 334 802 – tollfree  
E-Mail sales@sick.com.au

**Belgium/Luxembourg**

Phone +32 (0)2 466 55 66  
E-Mail info@sick.be

**Brasil**

Phone +55 11 3215-4900  
E-Mail sac@sick.com.br

**Canada**

Phone +1 905 771 14 44  
E-Mail information@sick.com

**Ceská Republika**

Phone +420 2 57 91 18 50  
E-Mail sick@sick.cz

**China**

Phone +86 4000 121 000  
E-Mail info.china@sick.net.cn  
Phone +852-2153 6300  
E-Mail ghk@sick.com.hk

**Danmark**

Phone +45 45 82 64 00  
E-Mail sick@sick.dk

**Deutschland**

Phone +49 211 5301-301  
E-Mail kundenservice@sick.de

**España**

Phone +34 93 480 31 00  
E-Mail info@sick.es

**France**

Phone +33 1 64 62 35 00  
E-Mail info@sick.fr

**Great Britain**

Phone +44 (0)1727 831121  
E-Mail info@sick.co.uk

**India**

Phone +91-22-4033 8333  
E-Mail info@sick-india.com

**Israel**

Phone +972-4-6801000  
E-Mail info@sick-sensors.com

**Italia**

Phone +39 02 27 43 41  
E-Mail info@sick.it

**Japan**

Phone +81 (0)3 3358 1341  
E-Mail support@sick.jp

**Magyarország**

Phone +36 1 371 2680  
E-Mail office@sick.hu

**Nederlands**

Phone +31 (0)30 229 25 44  
E-Mail info@sick.nl

**Norge**

Phone +47 67 81 50 00  
E-Mail austefjord@sick.no

**Österreich**

Phone +43 (0)22 36 62 28 8-0  
E-Mail office@sick.at

**Polska**

Phone +48 22 837 40 50  
E-Mail info@sick.pl

**România**

Phone +40 356 171 120  
E-Mail office@sick.ro

**Russia**

Phone +7-495-775-05-30  
E-Mail info@sick.ru

**Schweiz**

Phone +41 41 619 29 39  
E-Mail contact@sick.ch

**Singapore**

Phone +65 6744 3732  
E-Mail admin@sicksgp.com.sg

**Slovenija**

Phone +386 (0)1-47 69 990  
E-Mail office@sick.si

**South Africa**

Phone +27 11 472 3733  
E-Mail info@sickautomation.co.za

**South Korea**

Phone +82 2 786 6321/4  
E-Mail info@sickkorea.net

**Suomi**

Phone +358-9-25 15 800  
E-Mail sick@sick.fi

**Sverige**

Phone +46 10 110 10 00  
E-Mail info@sick.se

**Taiwan**

Phone +886-2-2375-6288  
E-Mail sales@sick.com.tw

**Türkiye**

Phone +90 (216) 528 50 00  
E-Mail info@sick.com.tr

**United Arab Emirates**

Phone +971 (0) 4 8865 878  
E-Mail info@sick.ae

**USA/México**

Phone +1(952) 941-6780  
1 800-325-7425 – tollfree  
E-Mail info@sickusa.com

More representatives and agencies  
at [www.sick.com](http://www.sick.com)