

Datasheet - TVS 400-12/BZ-M20

Safety switch for hinged guards (Archive) / TVS 400



Preferred typ



- thermoplastic enclosure
- Double-insulated
- Good resistance to oil and petroleum spirit
- 111,5 mm x 92 mm x 36 mm
- Simple fitting, especially on 40 mm profiles
- Universal fitting on guards hinged on left or right-hand side
- Fixing holes for M6 countersunk screws to DIN 965
- 2 cable entries M 20 x 1.5

(Minor differences between the printed image and the original product may exist!)

Ordering details

Product type description	TVS 400-12/BZ-M20
Article number	101155808
EAN code	4030661176673

Approval

Approval

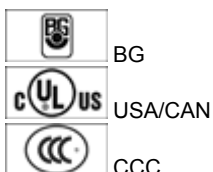

Classification

Standards	EN ISO 13849-1
B _{10d} Normally-closed contact (NC)	2.000.000
Mission time	20 Years
notice	$MTTF_d = \frac{B_{10d}}{0,1 \times n_{op}}$ $n_{op} = \frac{d_{op} \times h_{op} \times 3600 \text{ s/h}}{t_{cycle}}$

Global Properties

Product name	TVS 400
Standards	EN 60947-5-1, BG-GS-ET-15

Compliance with the Directives (Y/N) 

Yes

Materials

- Material of the housings	Plastic, glass-fibre reinforced thermoplastic, self-extinguishing
- Material of the contacts	Silver
- Material of the hinge	Aluminium
Housing coating	None
Weight	420 g

Mechanical data

Design of electrical connection	Screw connection
Cable entry M 20 x 1.5	2
Cable section	
- Min. Cable section	0,5 mm ²
- Max. Cable section	1 mm ²
Mechanical life	> 1.000.000 operations
Switching frequency	max. 120/h
Positive break angle	4 °
Positive break force	1 N
additional hinge (Y/N)	Yes
additional hinge (Y/N)	Yes
mounting hinge (Y/N)	Yes
notice	All indications about the cable section are including the conductor ferrules.

Ambient conditions

Ambient temperature	
- Min. environmental temperature	-25 °C
- Max. environmental temperature	+65 °C
Protection class	IP65

Electrical data

Design of control element	Normally open contact (NO), Opener (NC)
Switching principle	Creep circuit element
Number of auxiliary contacts	1 piece
Number of safety contacts	2 piece
Rated impulse withstand voltage U_{imp}	2.5 kV
Rated insulation voltage U_i	250 V
Thermal test current I_{the}	2.5 A
Utilisation category	AC-15: 230 V / 2 A, DC-13: 24 V / 1 A
Max. fuse rating	2 A gG D-fuse
Switching of low voltages	1 mA / 5 VDC

ATEX

Explosion protection categories for gases	None
Explosion protected category for dusts	None

Dimensions

Dimensions of the sensor	
- Width of sensor	111.5 mm

- Height of sensor	92 mm
- Length of sensor	36 mm

notice

The additional hinge including mounting accessories is also available separately, part number Z 400

Plug connection and mounting kits for profile sections of the most common makes on request

The opening angle has been set to 10° in factory.

Until the limit of the mechanical life has been reached the angle can increase up to 6° under normal wear-out conditions.

Diagram

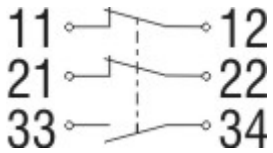

Note Diagram

- positive break NC contact
- active
- no active
- Normally-open contact
- Normally-closed contact

Switch travel diagram



Notes Switch travel diagram

- Contact closed
- Contact open
- Setting range
- Break point
- Positive opening sequence/- angle
- VS** adjustable range of NO contact
- VÖ** adjustable range of NC contact
- N** after travel

Ordering code

TVS 400-(1)/(2)

(1)	
12	1 Normally open contact (NO) / 2 Opener (NC)
03	3 Opener (NC)
(2)	
B	with mounting hinge
BZ	with mounting and additional hinge

Documents

Operating instructions and Declaration of conformity (fr) 328 kB, 07.08.2012

Code: mrl_tvs400_fr

Operating instructions and Declaration of conformity (es) 327 kB, 07.08.2012

Code: mrl_tvs400_es

Operating instructions and Declaration of conformity (cs) 326 kB, 06.08.2012

Code: mrl_tvs400_cs

Operating instructions and Declaration of conformity (sv) 330 kB, 24.08.2012

Code: mrl_tvs400_sv

Operating instructions and Declaration of conformity (da) 325 kB, 07.08.2012

Code: mrl_tvs400_da

Operating instructions and Declaration of conformity (pl) 328 kB, 07.08.2012

Code: mrl_tvs400_pl

Operating instructions and Declaration of conformity (pt) 328 kB, 07.08.2012

Code: mrl_tvs400_pt

Operating instructions and Declaration of conformity (it) 325 kB, 07.08.2012

Code: mrl_tvs400_it

Operating instructions and Declaration of conformity (en) 331 kB, 29.05.2012

Code: mrl_tvs400_en

Operating instructions and Declaration of conformity (jp) 399 kB, 07.08.2012

Code: mrl_tvs400_jp

Operating instructions and Declaration of conformity (de) 331 kB, 29.02.2012

Code: mrl_tvs400_de

Operating instructions and Declaration of conformity (nl) 327 kB, 07.08.2012

Code: mrl_tvs400_nl

BG-test certificate (de) 267 kB, 07.11.2005

Code: z_tv4p01

CCC certification (en) 577 kB, 12.12.2006

Code: q_349p02

CCC certification (cn) 609 kB, 12.12.2006

Code: q_349p03

Images

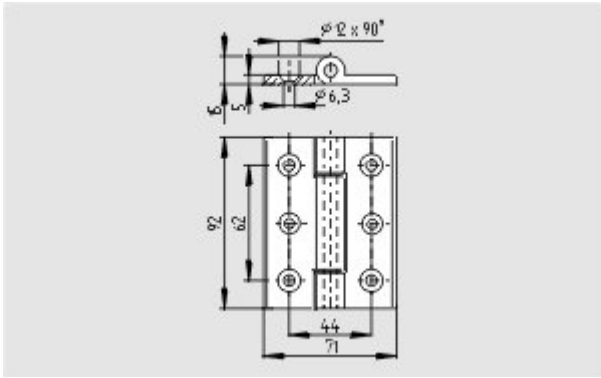

Dimensional drawing (basic component)

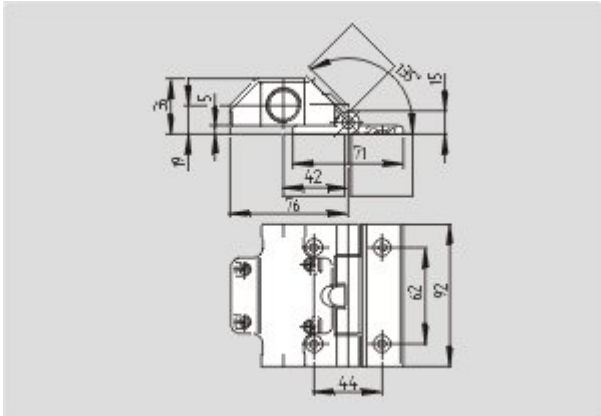

Dimensional drawing (basic component)

K.A. Schmersal GmbH & Co. KG, Mödinghofe 30, D-42279 Wuppertal

The data and values have been checked thoroughly. Technical modifications and errors excepted.

Generiert am 21.03.2014 - 10:18:43h Kasbase 2.2.18.F DBI

