

Insulated enclosure

250 × 160 × 95 mm

63 A / 80 A / 100 A

- Main/Emergency-Off Switch
- Main Switch

3 ... 4 pole

IP66

Insulated polycarbonate enclosure



Order code structure: Type - Switching programme - Mounting form
 Ordering example: 3 pole Main/Emergency-Off Switch, 80A, M-padlock device: **H408 - 41300 - 177M4**

Type	Rated data (IEC 60947)		
	Operational current I _e AC-21A (A)	Operational power (at 380–440V) AC-23A (kW) AC-3 (kW)	
H406	63	22	18.5
H408	80	30	22
H410	100	37	30

Detailed technical data page 108.

Switching progr.	Poles	Auxiliary contacts	
		n/o	n/c
41300	3	0	0
41311	3	1	1
41320	3	2	0
41400	4	0	0
41411	4	1	1
41420	4	2	0

Switching diagrams and further switching programmes (3 ... 4 pole) page 95.

Mounting form	Operator		Main/Emergency-Off Switch	Mounting form	Operator		Main Switch
	N	M			N	M	
177N4			N-padlock device yellow/red	177N1			N-padlock device black
177M4			M-padlock device yellow/red	177M1			M-padlock device black

Dimensions in mm:

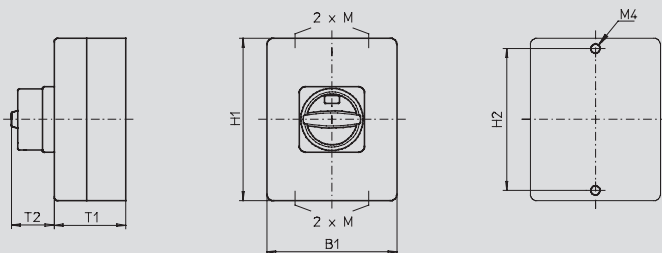

Mounting form	H1	B1	T1	T2	2xM	H2
177N4/177N1	250	160	95	45	25/32	240
177M4/177M1	250	160	95	50	25/32	240