

distribution blocks 125 to 400 A

four pole

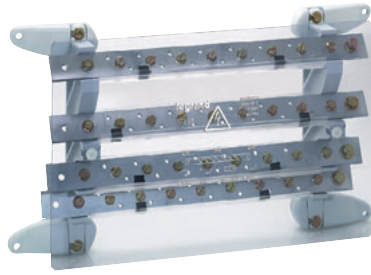

0374 00



0373 08

Extra-flat distribution blocks for lugs

Pack	Cat. Nos.	Extra-flat distribution blocks for lugs									
1	0374 47	<p>125 A screw type (60 mm depth) Ipk peak withstand current 25 kA Insulation voltage according to EN 60947-1/ IEC 60664-1 : 500 V Self-extinguishing : 960 °C</p> <p>Fix to \perp (15 mm high) or by M6 screws Four bars each equipped with :</p> <table border="1"> <tr> <td>Incoming</td> <td>Phase outgoing</td> <td>Neutral outgoing</td> <td rowspan="2">No. of 17.5 mm modules 16</td> </tr> <tr> <td>1 x 35 mm²</td> <td>10 x 16 mm² M5 screw</td> <td>17 x 16 mm² M5 screw</td> </tr> </table> <p>Clamp connection possible using connector Cat. No. 0373 65 (p. 45)</p>	Incoming	Phase outgoing	Neutral outgoing	No. of 17.5 mm modules 16	1 x 35 mm ²	10 x 16 mm ² M5 screw	17 x 16 mm ² M5 screw		
Incoming	Phase outgoing	Neutral outgoing	No. of 17.5 mm modules 16								
1 x 35 mm ²	10 x 16 mm ² M5 screw	17 x 16 mm ² M5 screw									
1	0374 00	<p>250 A (75.5 mm depth) Ipk peak withstand current 60 kA Insulation voltage according to EN 60947-1/ IEC 60664-1 : 1 000 V Self-extinguishing : 960 °C</p> <p>Fix to mounting plate by M6 screws Four bars each equipped with :</p> <table border="1"> <tr> <td>Incoming</td> <td>either</td> <td>Outgoing</td> </tr> <tr> <td>150 mm²</td> <td></td> <td>1 x 70 mm² or 1 x 50 mm² plus 1 x 35 mm² or 2 x 35 mm²</td> </tr> <tr> <td></td> <td>or</td> <td>1 connector Cat. No. 0374 03</td> </tr> </table>	Incoming	either	Outgoing	150 mm ²		1 x 70 mm ² or 1 x 50 mm ² plus 1 x 35 mm ² or 2 x 35 mm ²		or	1 connector Cat. No. 0374 03
Incoming	either	Outgoing									
150 mm ²		1 x 70 mm ² or 1 x 50 mm ² plus 1 x 35 mm ² or 2 x 35 mm ²									
	or	1 connector Cat. No. 0374 03									
1	0374 03	<p>Connector for Cat. No. 0374 00 converts outgoing terminal to :</p> <ul style="list-style-type: none"> • 1 x 1.5 to 6 mm² Ø 5.3 mm • 2 x 6 to 16 mm² Ø 7.5 mm <p>Dimensions : 29 x 29 x 16.8 mm</p> 									

Stepped distribution blocks for lugs

1	0373 95	<p>125 A (77 mm depth) Fix to \perp (15 mm high) or by M4 screws Four 12 x 4 mm bars each equipped with : • Five 2 x 10 mm² claw connectors per bar (not mounted)</p>				
1	0374 30	<p>125 A (125 mm depth) Fix to mounting plate by M6 screws Four 15 x 4 mm bars each equipped with :</p> <table border="1"> <tr> <td>Incoming</td> <td>Outgoing</td> </tr> <tr> <td>1 x 35 mm² - M8 screw</td> <td>5 x 25 mm² - M6 screw</td> </tr> </table>	Incoming	Outgoing	1 x 35 mm ² - M8 screw	5 x 25 mm ² - M6 screw
Incoming	Outgoing					
1 x 35 mm ² - M8 screw	5 x 25 mm ² - M6 screw					
1	0374 31	<p>160 A (125 mm depth) Fix to mounting plate by M6 screws Four 18 x 4 mm bars each equipped with :</p> <table border="1"> <tr> <td>Incoming</td> <td>Outgoing</td> </tr> <tr> <td>1 x 70 mm² - M8 screw</td> <td>5 x 35 mm² - M6 screw</td> </tr> </table>	Incoming	Outgoing	1 x 70 mm ² - M8 screw	5 x 35 mm ² - M6 screw
Incoming	Outgoing					
1 x 70 mm ² - M8 screw	5 x 35 mm ² - M6 screw					
1	0374 35	<p>250 A (155 mm depth) Fix to mounting plate by M6 screws Four 25 x 4 mm bars each equipped with :</p> <table border="1"> <tr> <td>Incoming</td> <td>Outgoing</td> </tr> <tr> <td>1 x 120 mm² - M10 screw</td> <td>5 x 50 mm² - M8 screw</td> </tr> </table>	Incoming	Outgoing	1 x 120 mm ² - M10 screw	5 x 50 mm ² - M8 screw
Incoming	Outgoing					
1 x 120 mm ² - M10 screw	5 x 50 mm ² - M8 screw					
1	0373 08	<p>400 A (107 mm depth) With front insulation sheet Four 32 x 5 mm bars equipped with :</p> <table border="1"> <tr> <td>Incoming</td> <td>Outgoing</td> </tr> <tr> <td>2 x Ø 8.5 mm holes for bar/flexible bar</td> <td>21 x M6 holes for 70 mm² max cable lugs</td> </tr> </table>	Incoming	Outgoing	2 x Ø 8.5 mm holes for bar/flexible bar	21 x M6 holes for 70 mm ² max cable lugs
Incoming	Outgoing					
2 x Ø 8.5 mm holes for bar/flexible bar	21 x M6 holes for 70 mm ² max cable lugs					

distribution blocks 125 to 400 A

four pole

Extra-flat distribution blocks for lugs

125 A Cat. No. 0374 47

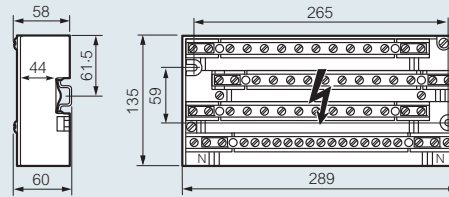

250 A Cat. No. 0374 00

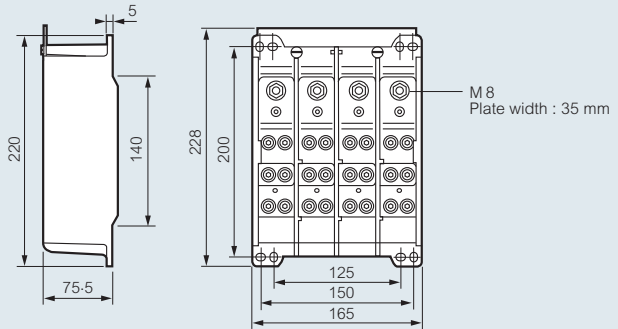

Stepped distribution blocks for lugs

125 A Cat. No. 0373 95 - Ipk peak withstand current 20 kA
 Insulation voltage according to EN 60947-1/IEC 60664-1 : 600 V
 Self-extinguishing : 850 °C

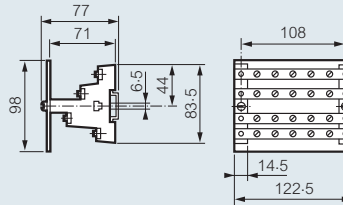

125/160/250 A Cat. Nos. 0374 30/31/35 - Ipk peak withstand current 35 kA
 Insulation voltage according to EN 60947-1/IEC 60664-1 : 1 000 V
 Impulse (surge) voltage (Uimp) : 12 kV
 Degree of pollution : 3 (conductive dust)
 Self-extinguishing : 850 °C

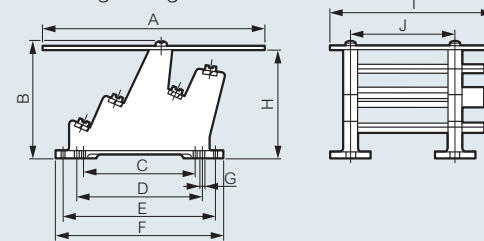

Dimensions (mm)

Rating	A	B	C	D	E	F	G	H	I	J
125 A	225	125	110	125	165	189	6.5	117.5	165	108
160 A	240	125	110	125	165	189	6.5	117.5	180	120
250 A	260	155	110	125	185	209	6.5	147.5	195	120

400 A (1) Cat. No. 0373 08 - Ipk peak withstand current 42 kA
 Insulation voltage according to EN 60947-1/IEC 60664-1 : 1 000 V
 Impulse (surge) voltage (Uimp) : 12 kV
 Degree of pollution : 3 (conductive dust)
 Self-extinguishing : 960 °C

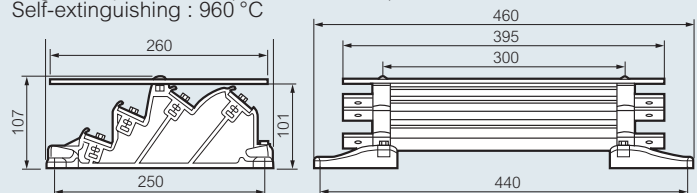

(1) It is recommended that the unit is fitted horizontally with a minimum face plate height of 300 mm