

distribution blocks

self assembly



Insulated supports (maximum 280 A)

For assembling distribution blocks of varying lengths using bars and connectors below. Supplied with insulated screws for mounting optional protective cover (except 0373 98).

Pack	Cat. Nos.	Insulated supports (maximum 280 A)	Mounting type
5	0373 96	Set of 2 insulated 4 pole supports For bars 12 x 2 or 12 x 4 mm	DIN rail 0044 16 supplied or M4 screws not supplied
10	0373 98	Single pole supports For bars 12 x 2 or 12 x 4 mm	by M4 screws supplied
10	0374 37	For bars 15 x 4, 18 x 4 or 25 x 4 mm	

Copper connector bars

With threaded holes

		Size (mm)	Threaded holes Ø mm	Pitch	Max. thermal rating (A)	Length (mm)
10	0373 88	12 x 2	M5	18	110	990
10	0373 89	12 x 4	M5	18	160	990
10	0374 33	15 x 4	M6	18	200	990
10	0374 34	18 x 4	M6	18	245	990
10	0374 38	25 x 4	M6	18	280	990
4	0374 19	32 x 5	M6	25	450	1750

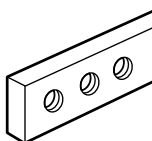

Connectors

Clamp type – For bars with threaded holes 12 x 4 (mm)

For one or two conductors
1.5 to 10 mm² (supplied with Ø 5 mm screw)

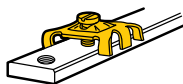

Cage type – For bare 12 x 4 mm bars

Capacity
100 0373 60 1.5 to 4 mm²
10 0373 61 6 to 16 mm²
10 0373 62 10 to 35 mm² (supplied with hexagonal 5 mm M6 screw)



Clips

For mounting on rail EN 60715 and 15 mm depth
10 0044 16 10 mm width
With threaded Ø 4 mm hole

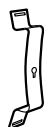

distribution blocks

self assembly

Copper connector bars with threaded holes

Cat. Nos. 0373 88/89

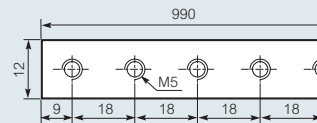

Cat. No. 0374 33/34

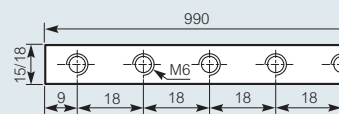

Cat. No. 0374 38

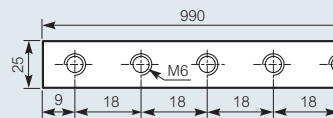

Cat. No. 0374 19

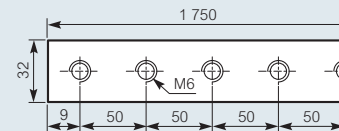

Cat. Nos.	Size	lthe (A)	lc (A)
0373 88	12 x 2	110	80
0373 89	12 x 4	160	125
0374 33	15 x 4	200	160
0374 34	18 x 4	245	200
0374 38	25 x 4	280	250
0374 19	32 x 5	450	400

Current ratings according to EN 60947-1 :

- lth : bars in free air
- lthe : bars enclosed with ventilation
- lc : bars totally enclosed in a weatherproof enclosure

Insulated supports four pole :

Insulation voltage according to EN 60947-1/IEC 60664-1 :
Cat. No. 0373 96 : 690 V - Impulse voltage (surge) (Uimp) : 8 kV
Degree of pollution (conductive dust) : 3
Distance between supports (mm)

Cat. Nos.	0373 96
Bar size	12 x 4 (12 x 2)
In (A)	125 (80)
Peak withstand current (kA)	
10	400 (200)
15	300 (150)
20	200 (125)
25	150 (100)
30	-
35	-
40	-

Cat. No. 0373 96

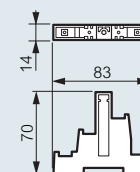

Insulated supports single pole

Insulation voltage according to EN 60947-1/IEC 60664-1 : 500 V
Impulse voltage (surge) (Uimp) : 8 kV
Degree of pollution (conductive dust) : 3

Cat. No. 0373 98

Front view for 12 x 2 mm bar

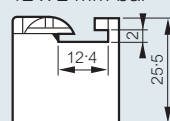

View from above

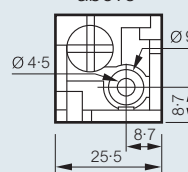

Front view for 12 x 4 mm bar

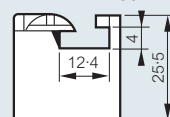

Cat. No. 0374 37

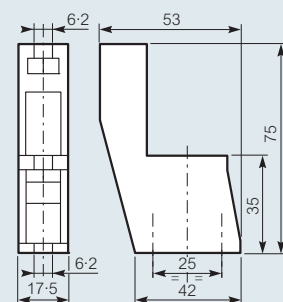

Max. space between 2 supports :
bar size 12 x 2 : 20 cm, 12 x 4 : 25 cm

The distance between supports can be determined using the chart. Select the peak withstand current (kA rating) and the distance between bars - dimension E (mm) after choosing your bar and support. Distance between supports (mm)

Cat. Nos.	0373 98				0374 37			
Bar size	12 x 2/12 x 4				15 x 4/18 x 4/25 x 4			
In (A)	80/125				160/200/245			
E (mm)	50	75	100	125	50	75	100	125
Peak withstand current (kA)								
10	400	600	800	-	350	600	750	-
15	300	450	600	800	250	400	500	700
20	250	350	450	600	150	225	300	375
25	200	250	300	400	125	150	200	250
30	-	-	-	-	100	125	150	175
35	-	-	-	-	-	100	125	150
40	-	-	-	-	-	-	-	-